

WING - C

B

FIRE REFUGE TERRACE ABOVE AT (+22850)

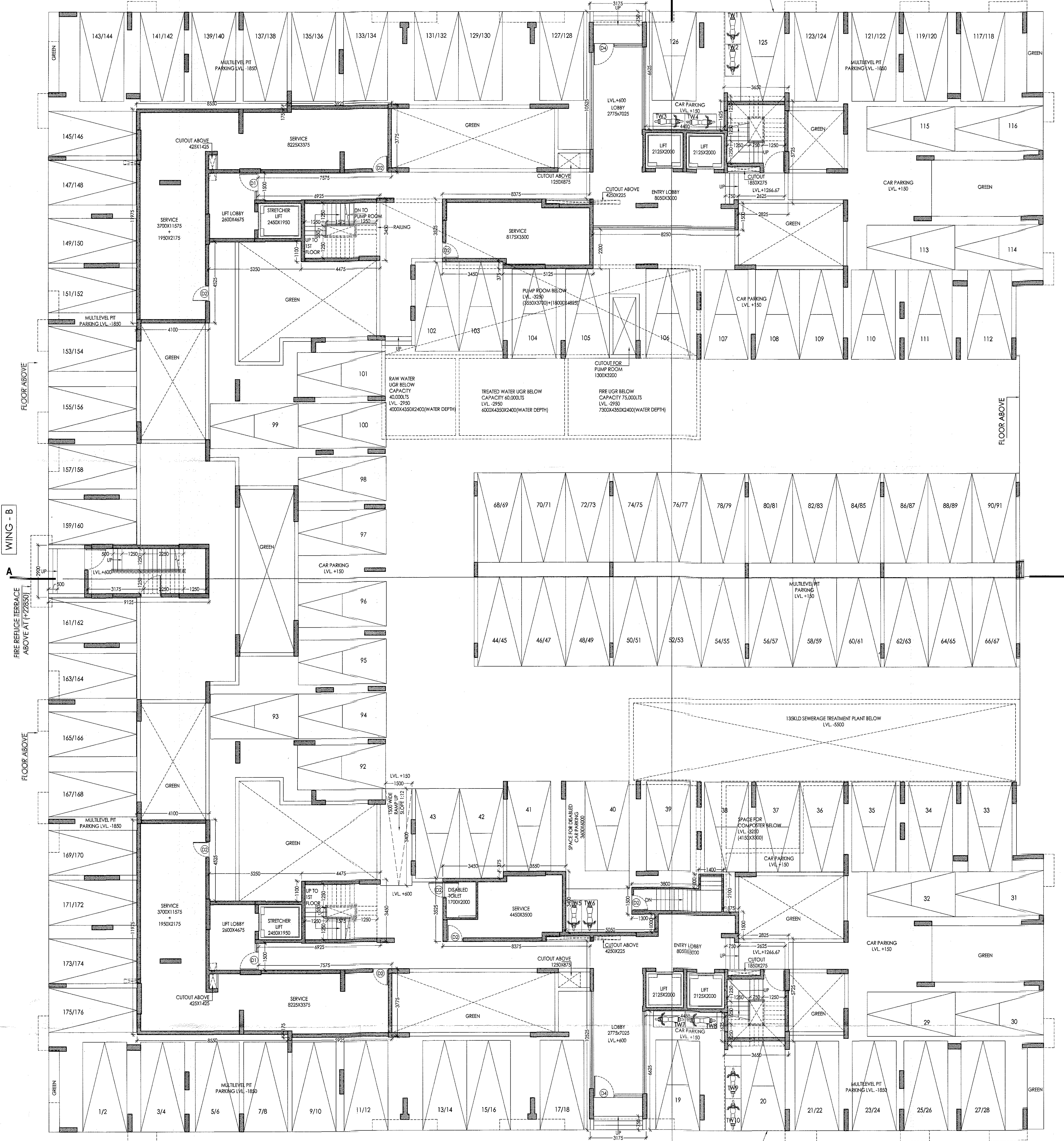

WING - B

FIRE REFUGE TERRACE ABOVE AT (+22850)

FLOOR ABOVE

FLOOR ABOVE

FLOOR ABOVE

FLOOR ABOVE

FLOOR ABOVE

FLOOR ABOVE

FLOOR ABOVE

FLOOR ABOVE

FLOOR ABOVE

GROUND FLOOR PLAN

WING - A

BOARD MEETING DATE 11.01.2023

B

FIRE REFUGE TERRACE ABOVE AT (+22850)

DOOR & WINDOW SCHEDULE						
DOORS			WINDOWS			
S. No.	LABEL	WIDTH	LINTEL	LABEL	WIDTH	LINTEL
1	D1	1050	2100	W1	1500	800
2	D2	900	2100	W2	600	1150
3	D3	750	2100	W3	900	800
4	D4	1200	2100	W4	1200	800
5	D5	2000	2100	W5	1100	150
6	SD1	2400	2350	W6	1650	150
7	SD2	1800	2350	W7	4800	1200
8	SD3	2000	2350	W8	900	1150
				DW1	750+800	1150

SANCTIONED
 On 20/02/2023
 P/A No. 2002/2023
 VALID UPTO 21/02/2026
 CHAIRMAN
 Madhyamgram Municipality
 Dist. - North 24-Parganas

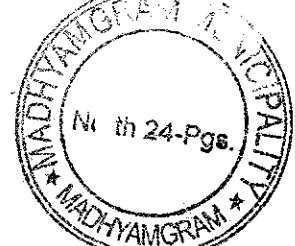

কক্ষপক্ষে ২টি পরিবেশ বন্ধ পাত
 যেমন কপাল, পলাশ, ছাতিম, নিত্য
 যেমনকি জলসহি লাগানো হবে।
 পরিবেশ সুরক্ষার হাফেজ
 নৌর প্রধান
 মহানগর পৌরসভা

DRAWING TITLE		DRG No. : IN/1288/CORP/ARCH/03			
GROUND FLOOR PLAN		JOB No. :	IN/1288	DRAWN BY	DRC
NORTH		SCALE	1:100	CHECKED BY	A. B.
		DATE	02.11.22	APPVD. BY	A. B.
		ISSUED FOR	SANCTION		

TITLE	SPECIFICATIONS	DECLARATION BY ARCHITECT	DECLARATION BY STRUCTURAL ENGINEER	SIGNATURE OF THE OWNER	ARCHITECT
PROPOSED G+XI STORED RESIDENTIAL BUILDING AT MOUZA- DOHARIA, JL NO: 45, TOUZI NO - 146, RS DAG NOS. 1300, 1301 & 1302, RS KHATIAN NOS. 905, 197 AND 116, LR DAG NOS. 1300, 1301 & 1302, LR KHATIAN NO. 3347, 3348, 3349, 3350, 3351, 3352, 3353, 3354, 3355, 3356, 3357, 3358 & 3359, PS- MADHYAGRAM (BARASAT) DISTRICT - 24 PARGANAS NORTH, WARD NO. - 25, HOLDING NO - 2, OLD JESSORE ROAD UNDER MADHYAGRAM MUNICIPALITY.	1. ALL DIMENSIONS ARE IN MM 2. ALL EXTERNAL WALLS ARE 200 THK. AAC BLOCK WITH 20mm PLASTER UNLESS OTHERWISE MENTIONED 3. ALL INTERNAL WALLS ARE 100 THK AAC BLOCK WITH 15mm PLASTER UNLESS OTHERWISE MENTIONED. 4. CEILING PLASTER IS 10mm 5. ALL P.C.C. WORK IN 1:3:6 6. ALL R.C.C. WORK IN 1:2:4 7. ALL OTHER SPECIFICATIONS CONFORMING RELEVANT I.S. CODE.	I CERTIFY THAT THE BUILDING PLAN HAS BEEN DRAWN UP AS PER PROVISION OF WEST BENGAL MUNICIPAL BYE-LAWS 2007 AS AMENDED FROM TIME TO TIME AND AS PER THE SITE CONDITION WHEREIN 25' OF ROAD ON THE WEST AND THE PLOT IS TOTALLY VACANT. THE PLOT IS BOUNDED BY BOUNDARY WALL/PILARS AND IT WITH THE PLAN IN A BUILDABLE SITE AND NOT A TANK. JISHNU PAL B.Tech (Civil), M.E (Gen-tech) I.C. Reg. No: G.T/1423 ANIRBAN BHADURIMONDAL I.C. Reg. No: G.T/1423 CA/2003/31394	THE STRUCTURAL DESIGNS AND DRAWINGS OF BOTH FOUNDATION AND SUPERSTRUCTURE OF THE BUILDING HAS BEEN MADE BY ME CONSIDERING ALL POSSIBLE LOADS INCLUDING THE SEISMIC LOAD AS PER NATIONAL BUILDING CODE OF INDIA AND CERTIFY THAT IT IS SAFE AND STABLE IN ALL RESPECTS. ANKIT AGARWALA F.I.E.-F212801 KMC Empowered Structural Engineer Class - I, E.S.R. - (I) 5910 ANKIT AGARWALA ESE/1172	SHITIJ REAL ESTATES LLP Partner / Designated Partner / Authorized Signatory	INNOTE 26/2, BALLYGUNGE CIRCULAR ROAD, UDAYAN PARK, 3rd. FLOOR TEL : (033) 4000-6424, 6425, 6426 KOLKATA - 700 019 www.innoteindia.com

THIS DRAWING IS A PRIVATE AND CONFIDENTIAL DOCUMENT AND IT MUST NOT BE COPIED OR LENT WITHOUT THE CONSENT OF INNOTE.